

APPROX LOCATION OF OVERHEAD ELECTRIC CABLES

PLAN SCALE 1:50

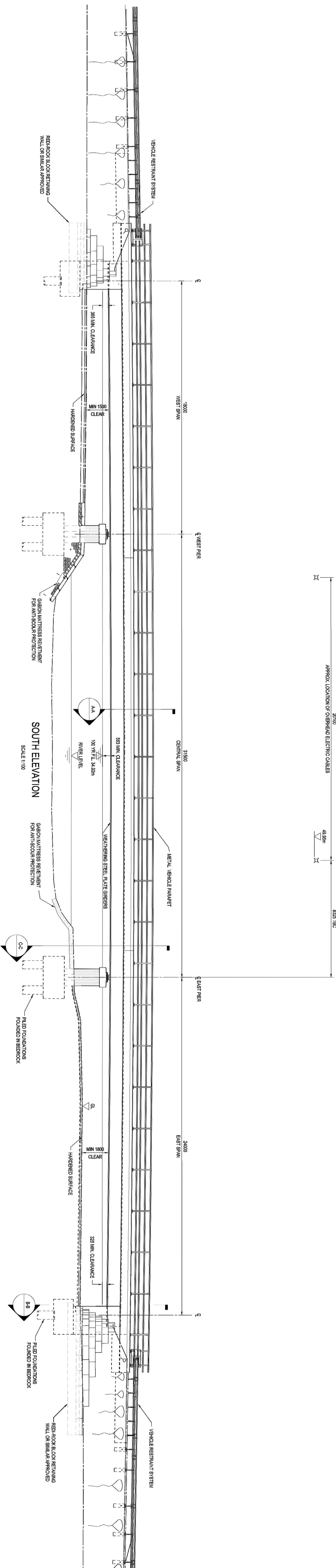

SOUTH ELEVATION SCALE 1:100

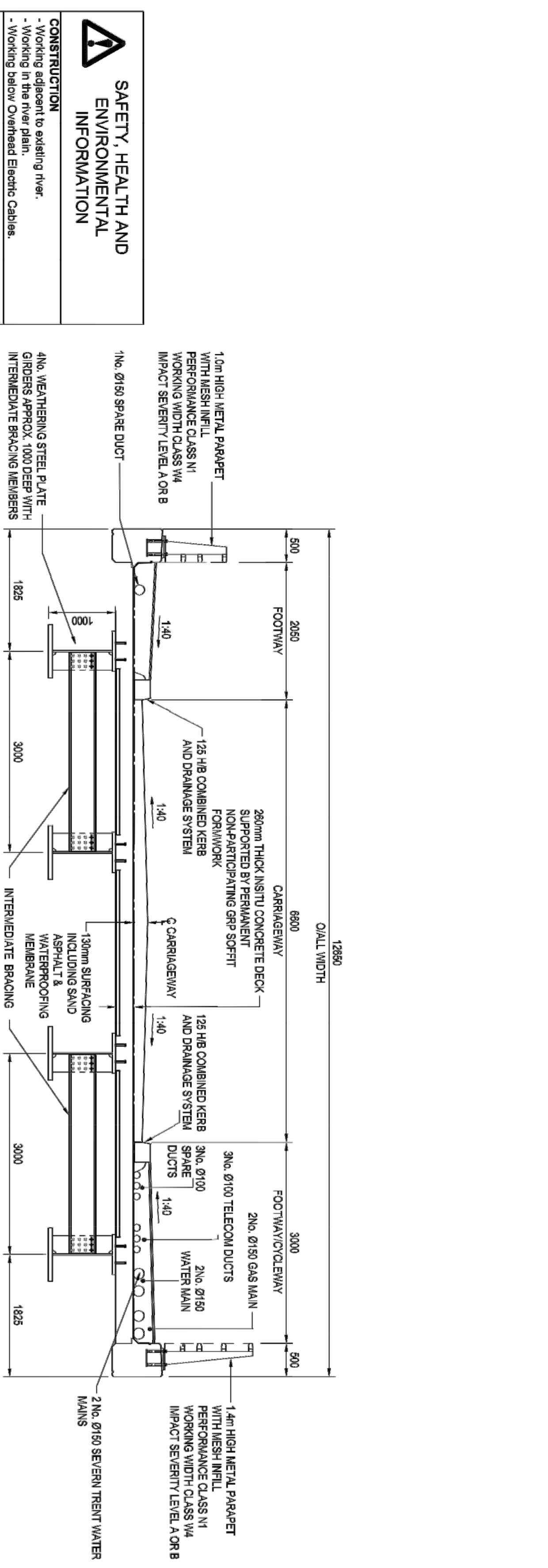

TYPICAL SECTION A-A CROSS SECTION SHOWING TYPICAL DETAILS SCALE 1:50

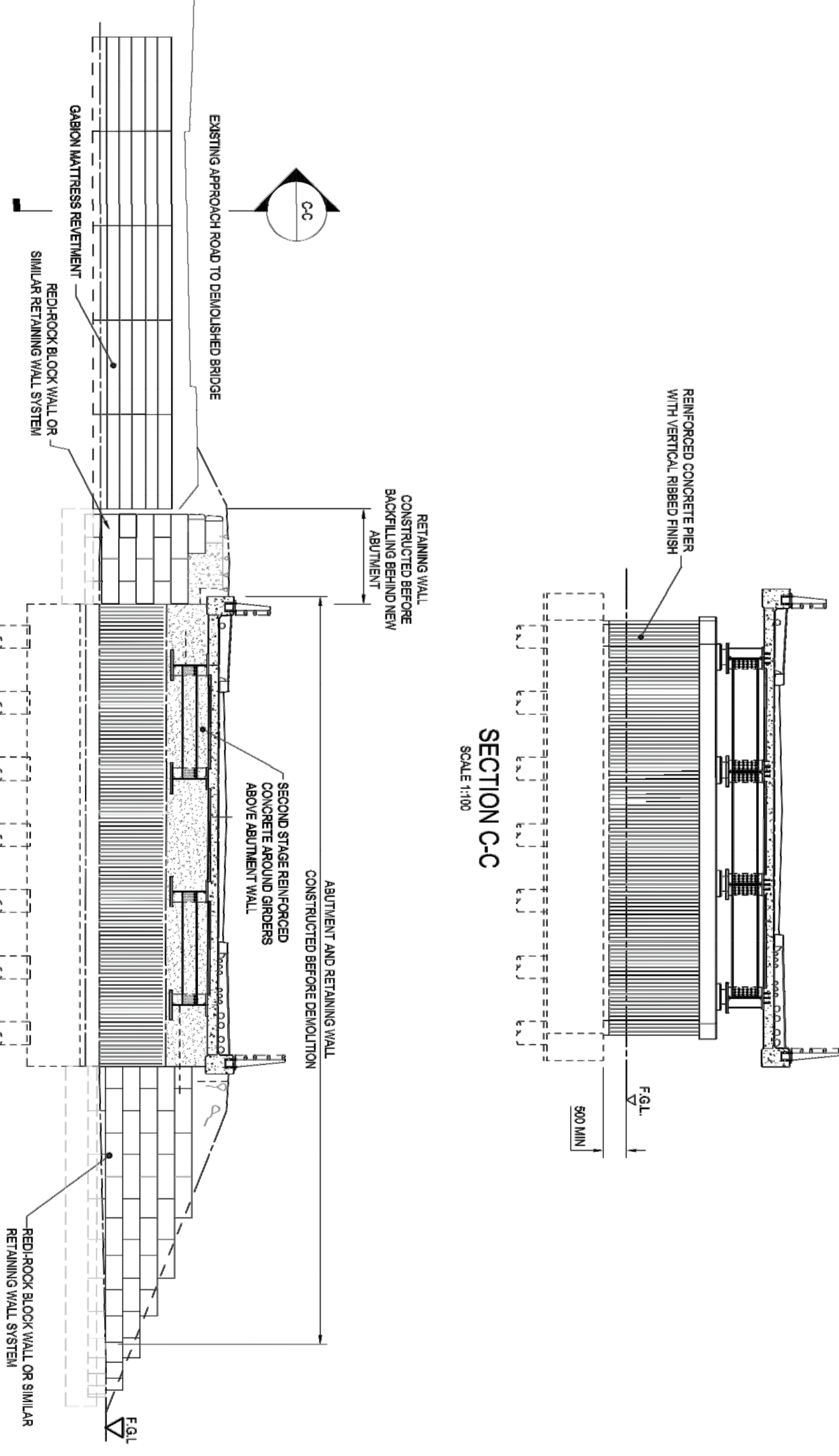

SECTION C-C SCALE 1:100

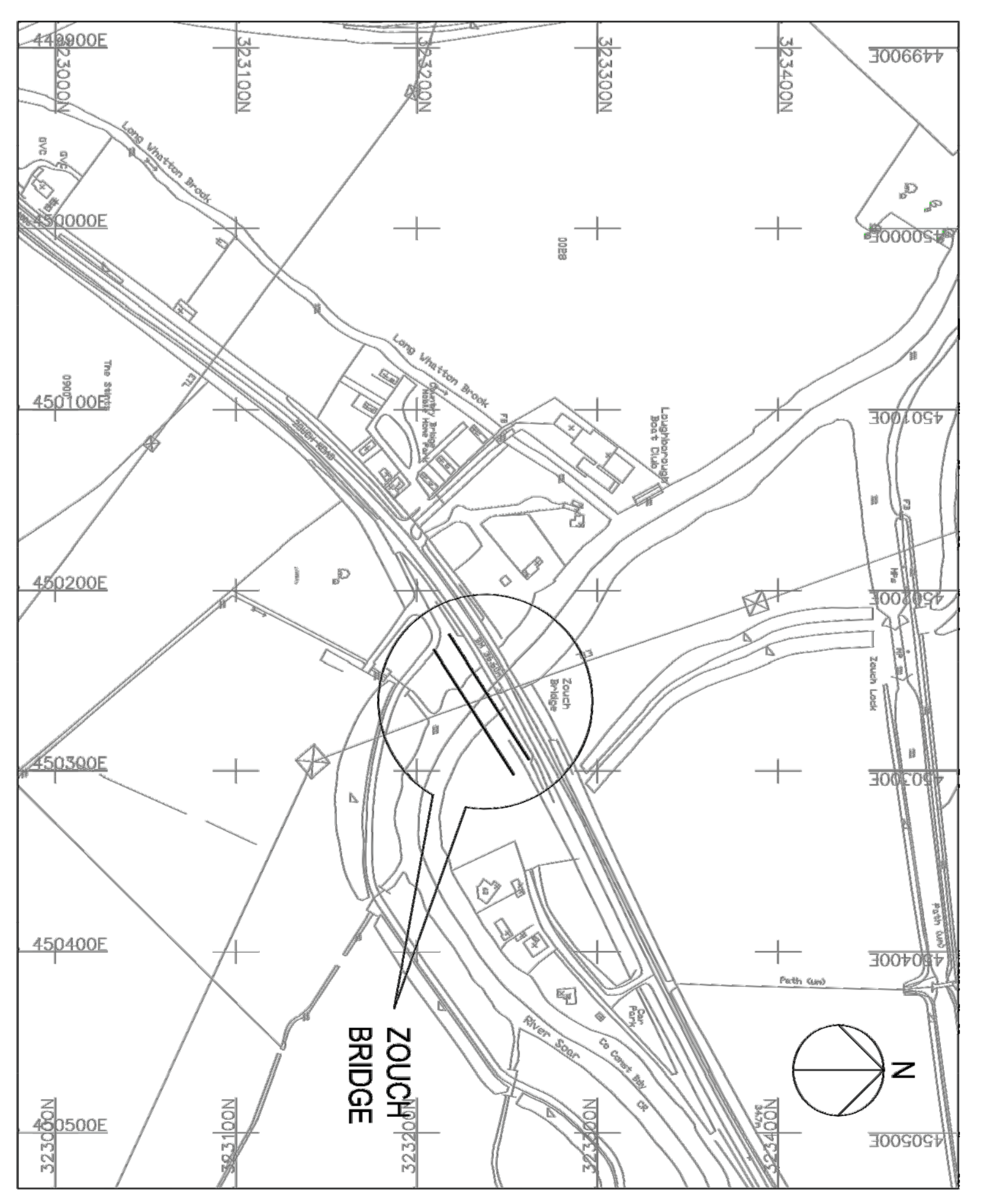

LOCATION PLAN SCALE 1:500

<p><b>SAFETY, HEALTH AND ENVIRONMENTAL INFORMATION</b></p> <p><b>CONSTRUCTION</b></p> <ul style="list-style-type: none"> <li>- Working adjacent to existing river.</li> <li>- Working in the river piers.</li> <li>- Working on the river bed.</li> <li>- Working adjacent to live traffic.</li> </ul> <p><b>MAINTENANCE</b></p> <ul style="list-style-type: none"> <li>- Working in the river piers.</li> <li>- Working on the river bed.</li> <li>- Working adjacent to live traffic.</li> </ul> <p><b>DECOMMISSIONING / REMOVAL</b></p> <ul style="list-style-type: none"> <li>- Working in the river piers.</li> <li>- Working on the river bed.</li> <li>- Working adjacent to live traffic.</li> </ul> <p>It is assumed that all works will be approved and by a competent Contractor, working where appropriate to a method statement approved by the Client.</p>		<p><b>NOTES</b></p> <ol style="list-style-type: none"> <li>1. THE DRAWING IS TO BE READ IN CONJUNCTION WITH THE CONTRACT DOCUMENTS AND THE SUPPLEMENTARY CONDITIONS AND IN PARTICULAR THE GENERAL CONDITIONS OF CONTRACT AND THE PARTICULAR CONDITIONS OF CONTRACT.</li> <li>2. THE DRAWING IS TO BE READ IN CONJUNCTION WITH THE CONTRACT DOCUMENTS AND THE SUPPLEMENTARY CONDITIONS AND IN PARTICULAR THE GENERAL CONDITIONS OF CONTRACT AND THE PARTICULAR CONDITIONS OF CONTRACT.</li> <li>3. THE DRAWING IS TO BE READ IN CONJUNCTION WITH THE CONTRACT DOCUMENTS AND THE SUPPLEMENTARY CONDITIONS AND IN PARTICULAR THE GENERAL CONDITIONS OF CONTRACT AND THE PARTICULAR CONDITIONS OF CONTRACT.</li> </ol>	
<p><b>BRIDGE SCHEME</b></p>		<p><b>LEICESTERSHIRE COUNTY COUNCIL ENVIRONMENT AND TRANSPORT DEPARTMENT</b></p>	
<p><b>PROJECT</b></p>		<p><b>A006 ZOUCH BRIDGE REPLACEMENT</b></p>	
<p><b>DATE</b></p>		<p><b>11.01.2016</b></p>	
<p><b>THE LEICESTERSHIRE COUNTY COUNCIL (ZOUCH BRIDGE REPLACEMENT) BRIDGE SCHEME 2016</b></p>		<p><b>URRS</b></p>	
<p><b>PROJECT NO</b></p>		<p><b>MC0303-008</b></p>	